



747 Commercial Road, London, E14

BUTLER & STAG



## Charming two bedroom apartment set within a grade II listed building steeped in history close to Limehouse station.



- Two Bedroom Apartment
- Resident Amenities
- Vibrant Location
- Part Furnished
- Historical Building
- Limehouse Station Nearby
- Good Order Throughout
- Available from 2nd May 2026

Situated on the second floor and providing 700 Sq/Ft of accommodation, the property comprises of a large reception space which is semi open-plan to a fully integrated kitchen, two near-identically sized double bedrooms with fitted wardrobes, a smart bathroom and hallway storage.

The Mission Building, once known as the Empire Memorial Sailors' Hostel is a secure development with entry system, lift access, communal gardens, a roof terrace with panoramic views and bike storage. Also included are a small-scale gym that's exclusive to residents and a porter service from Monday to Friday.

The location is a convenient and vibrant one, with Limehouse station and an array of amenities nearby, as well as the Limehouse Cut and Basin offering the opportunity for serene walks and runs along the water.

Offered part furnished and available from 2nd May 2026.

EPC Rating D  
Council Tax Band D





## The Mission Building

Approx. Gross Internal 65.03 Area Sq M ( 700 Sq Ft )

BUTLER & STAG

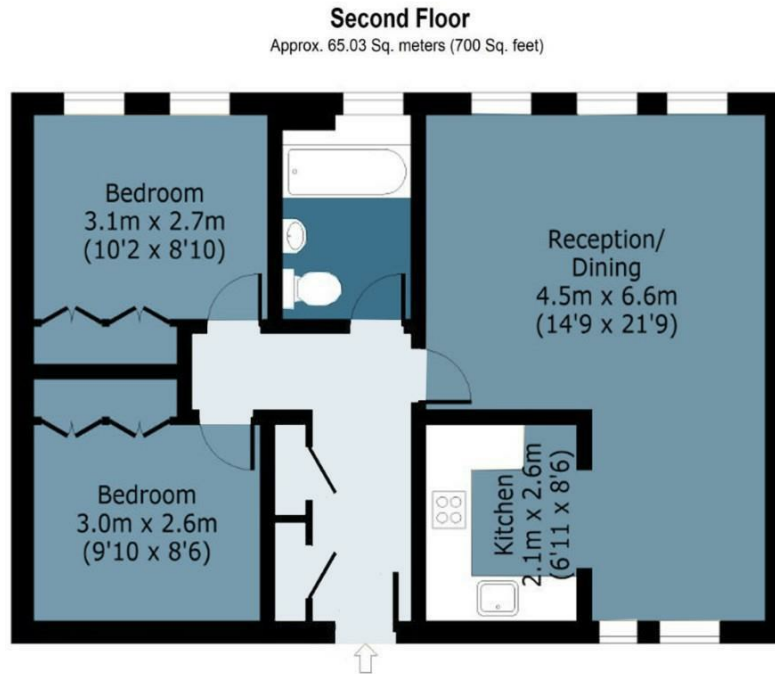

Measurements are approximate and for illustration purposes only. While we do not doubt the accuracy and completeness, we advise you conduct a careful independent assessment of the property to determine monetary value.  
© @modephoto.uk www.modephoto.co.uk

BUTLER & STAG

☎ 020 8102 1236

🏠 508 Roman Road, Bow, London, E3 5LU

✉ bow@butlerandstag.com

[www.butlerandstag.uk](http://www.butlerandstag.uk)

IMPORTANT NOTICE - These particulars have been prepared in good faith and they are not intended to constitute part of an offer or contract. We have not performed a structural survey on this property and the services, appliances and specific fittings have not been tested. All photographs, measurements, floor plans and distances referred to are given as a guide and should not be relied upon.